



CHORUS 46

 (single and double leaf)
 TIMBER FIRE-RATED
 AND ACOUSTIC DOORSETS

DOOR LEAF

- Huet multi-layer acoustic core
- Thickness: 51mm hardwood stiles all round
- High stability leaf due to the inclusion of 2 steel sheets

DOOR FRAME

- Hardwood
- Rebated monoblock frame
- Variety of widths
- Extension linings available
- Frame can be lacquered, stained or varnished
- Frame can be wrapped with wood veneer to match door leaf facings

CHOICE OF DOOR FACINGS

- Primed
- Wood veneers
- Laminated
- White paint finish + other colour available by request
- Grooved to a wide choice of standard and bespoke finishes

IRONMONGERY

- 4 lift-off hinges - 160 x 70mm black or stainless steel
- Cut-outs/mortices are available to suit a variety of locks and handles
- Cut-outs/mortices are available to suit a large choice of electromagnetic lock
- Spy hole
- Concealed door closer available: DORMA ITS96
- Electric striking plate (available on single leaf)

PERIMETER SEALS

- Intumescent seals factory fitted (within the frame and leaf)
- Combined smoke and acoustic seals fitted within the frame and leaf
- Large thresholds selection



46dB (FCBA 404-07-101-7)



EI30 (FD30)
(EITHER SIDE - CSTB RS14-089)



3c Stability*



Smoke Seal (S_a Classification)
(EN 13501-2/BS EN 1634-3)

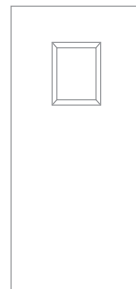

400x300

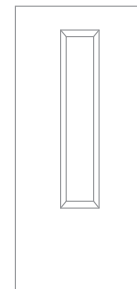

1200x200

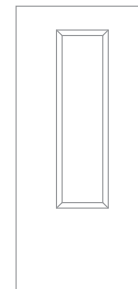

1200x300

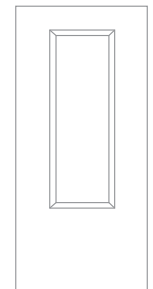

1200x400

*Stability of the door leaf is an important factor, particularly in areas of temperature variance between rooms or between rooms and corridors. Any distortion of the door leaf will result in the seals not functioning correctly. With the inclusion of a minimum of 2 steel sheets and other materials, Huet door leaves offer less than 2mm of distortion. The result is a door leaf and seal which continues to perform even with wide temperature differences.



CHORUS 46 (single and double leaf)

TIMBER FIRE-RATED
AND ACOUSTIC DOORSETS

All sizes are in mm

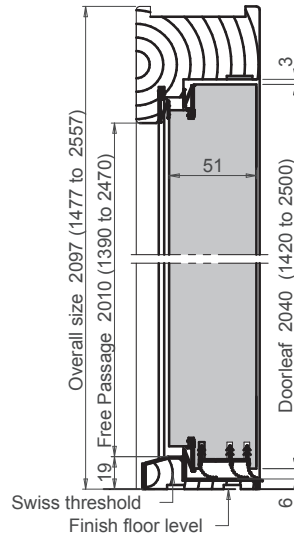
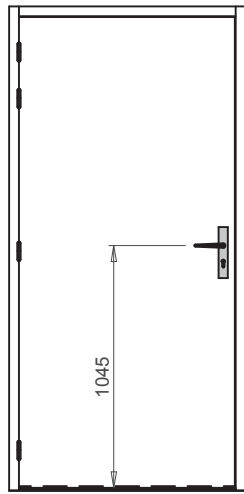

Swiss threshold 35x20

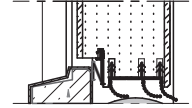

Swiss threshold 50x20

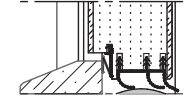

Swiss threshold 67x19

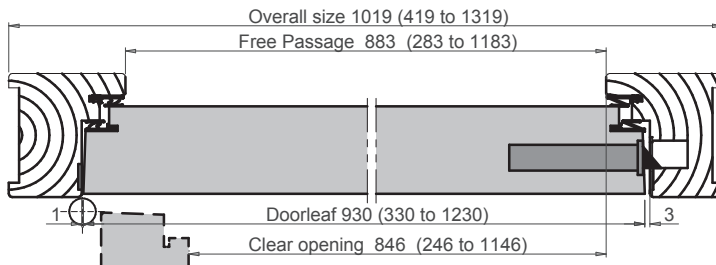
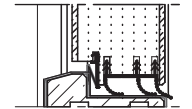

Pyramidal threshold 67x15

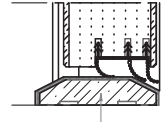

Flat threshold 35x12

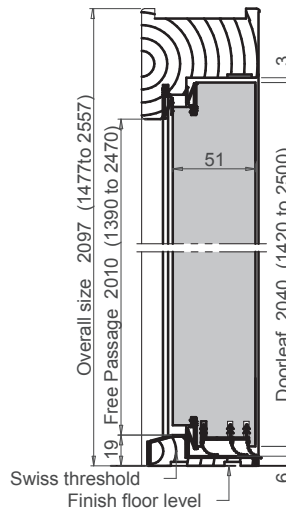
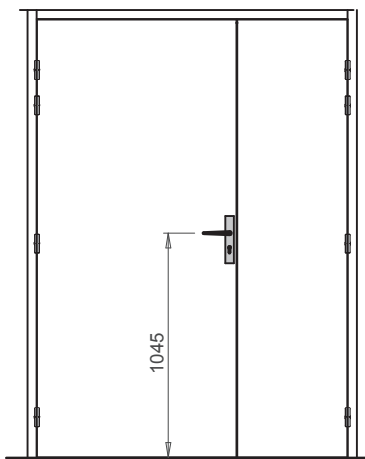
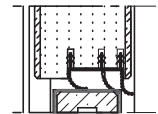

Lip seal

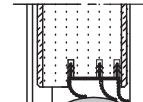

Mechanical drop seal

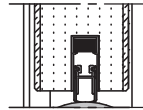

Flat threshold 35x12

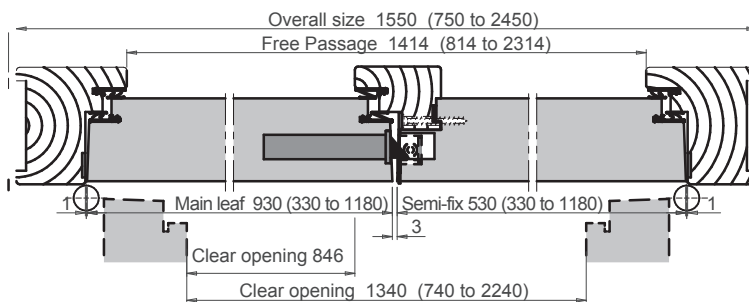
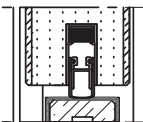

Pyramidal threshold 67x15

